

Imagine you had 40 one-metre sections of fencing.

**What is the largest rectangular area of land you could fence off?**



Now imagine you could build your fence up against a wall, so you only need to use the fence for three sides of the enclosure:

**What is the largest area you can fence off now?**

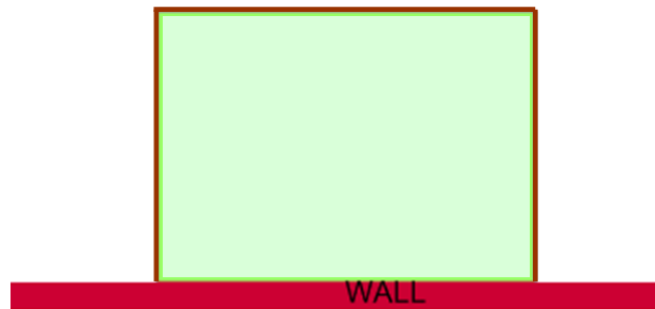

Now imagine you can attach the fence to the wall shown below, at the point marked X.

**What is the largest area you can fence off now?**

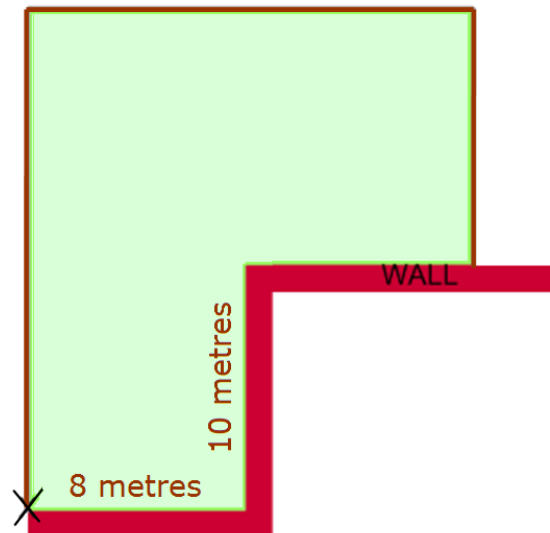

### Extension

Could you enclose even greater areas if you had 40m of flexible wire fencing that could fence off curves as well as straight lines?