

**This is how Anna started:**

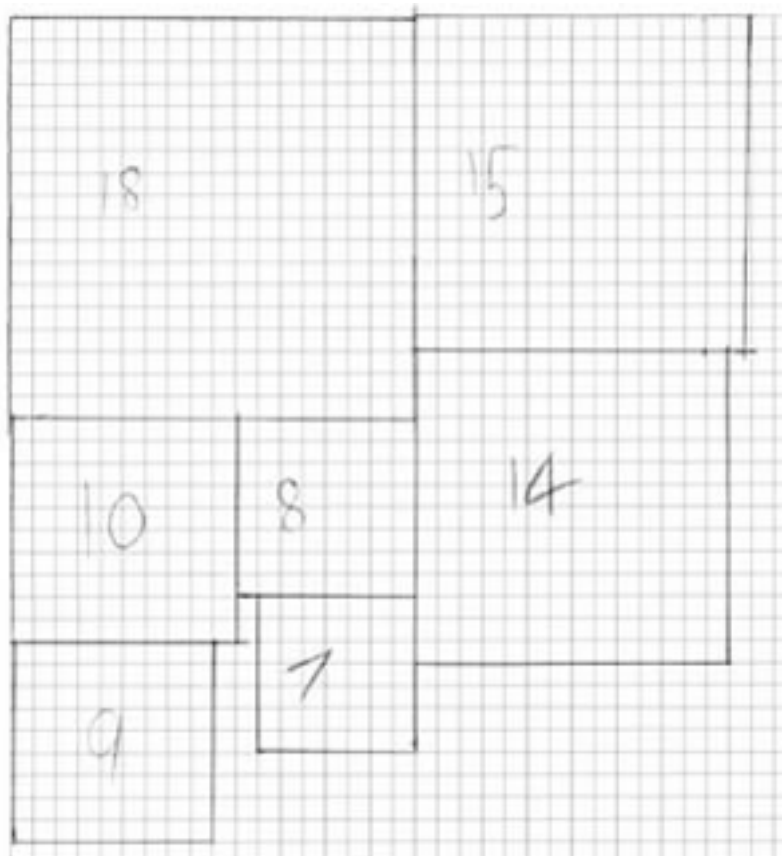

**Here is what Brendan tried:**



Here is Chandra's initial approach to the problem:

1	1	
4	16	
7	49	
8	64	
9	81	
10	100	
14	196	
15	225	
18	324	

Area:

1056

$528 \div 2$

$264 \div 2$

$132 \div 2$

$66 \div 2$

33

1056

8

Can you take each of these starting ideas and develop them into a solution?